

INSTRUCTION MANUALFOR BASKETBALL STAND



WARNING:
IMPROPER INSTALLATION OR
SWINGING ON THE RING MAY
CAUSE SERIOUS INJURY
OR DEATH

Notice to assemblers:

- *All the basketball systems,including those used for displays must be assembled and ballasted according to instructions.Failure to follow instructions could result in serious injury.
- *Please read all warnings and cautions before assembly.It is recommended to supervise children as they play with this product.This product is to be assembly by 2 adults only!

SAFETY INSTRUCTIONS

- To ensure safety,do not to assemble this system without following the instructions.Check entire box and inside all packing material for parts before assembly. A high probability of serious injury exists if this system is not installed,maintained and operated properly
- * The system should be moved by at least 3 adults capable of handling its weight.children should not be allowed to move the system.
 - *Check base(if applicable) regularly for leakage.slow leaks could case the system to tip over unexpectedly
 - *Stand in front of the system and pull the pole forward until the system is balanced on its wheels
 - * Move the system to the desired location and carefully set the base down.

! warning

- 1.Do not hang on the rim or any parts of the system including backboard ,support braces or net
- 2 Never play on damaged equipment.any problem with parts please contact the customer service promptly
- 3.Do not leave the system in an upright position without filling base with weight.as system may tip over cause injury
- 4.Do not allow the water to freeze in base during sub-freezing weather.please pour out the water and fill up the base with sand
- 5 Keep top pole and lifter pole covered with cap all the time
- 6 During play,do not wear jewelry(watches necklaces,etc.) avoid entangling in net or losing
- 7.when adjusting height or moving system,keep hands and fingers away from moving parts
- 8.Do not allow children to move or adjust the system

Height adjustment

As shown in the figure, Pinch the lifting handle bar in (HH),make the rim up and down.

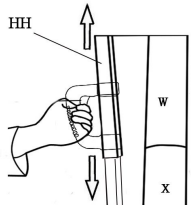

Product moving

- 1.Adjust the product in lowest level before moving
- 2.Avoid friction with the ground while moving
- 3.Move to the right place then rise the product slowly

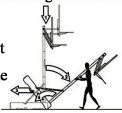

SPARE PARTS

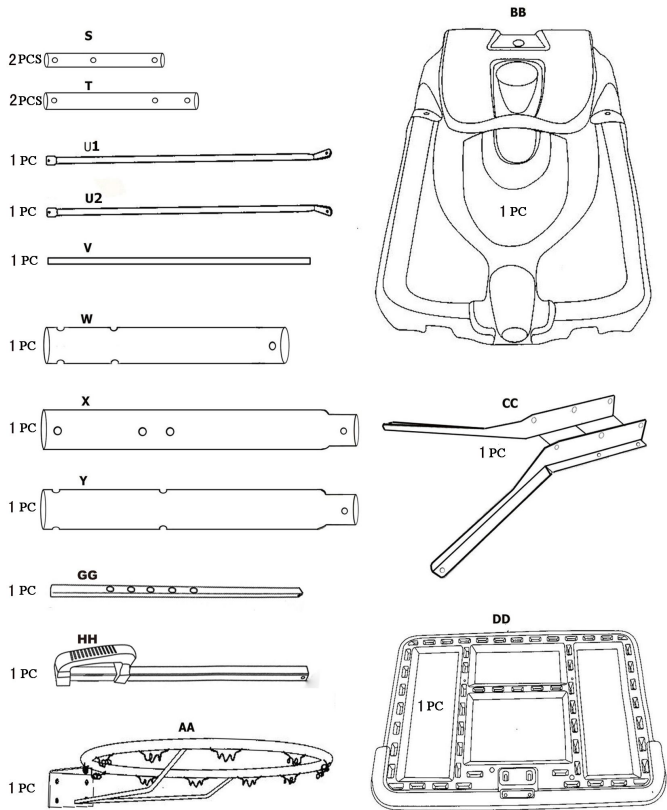
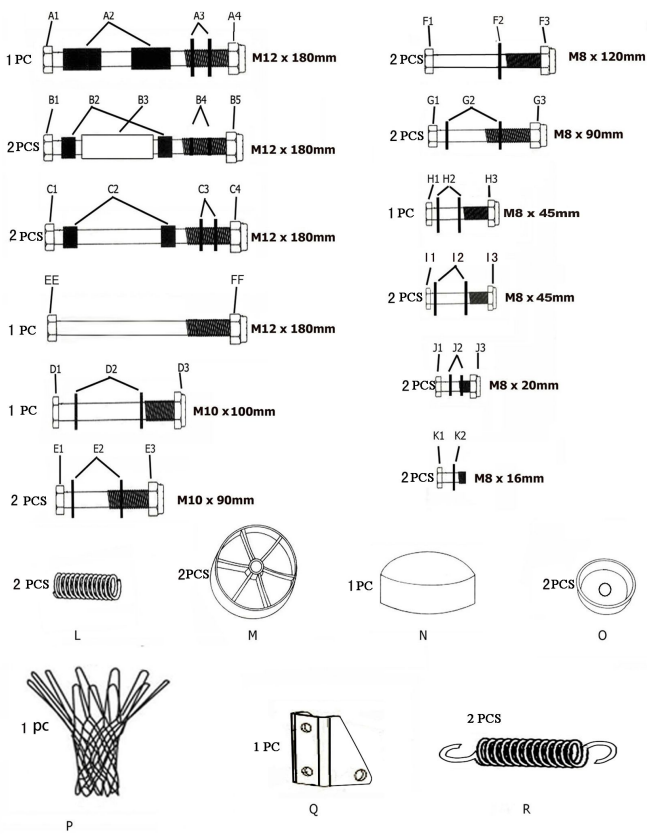

As shown in the right figure, connect top pole(W) and middle pole(X) in order to convenient the next installation of bolt fixed. please pay attention to the direction of holes

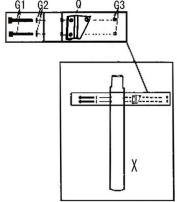

As shown in the figure, When the pole joint has burr or pipe end deformation, strike the bottom of the pole firmly 3 to 4 times on a piece of wood or cardboard

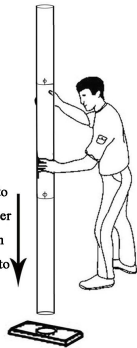

As shown in the left figure insert the top end of bottom pole (Y) into the end of middle pole (X) in order to convenient the next installation of bolt fixed, please pay attention to the direction of holes

As shown in the above figure, install the triangular block (Q) on middle pole (X) by bolt (G1),(G2),(G3)

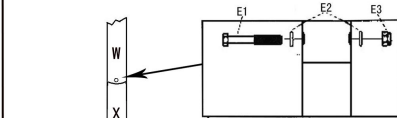

- (1). Fix the top pole(W), middle pole(X) and bottom pole(Y) together by bolt(E1,E2,E3)
- (2) As shown in the figure, Insert wheel shaft(V) into the base(BB), wheel(M) and bottom pole(Y). Please make sure that the triangular block(Q) must face to the back after installation.

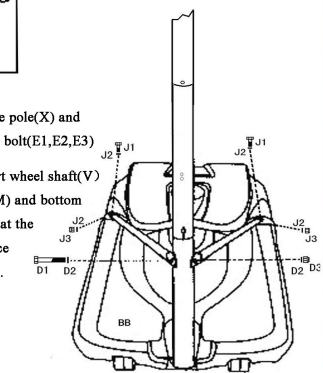
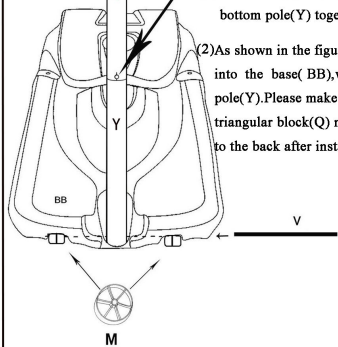

As shown in the figure, fix the pole brace(U1,U2) on bottom pole(Y) and base(BB) by bolt(D1,D2,D3) and bolt(J1,J2,J3). Please pay attention to the upper and lower directions of the pole brace

5

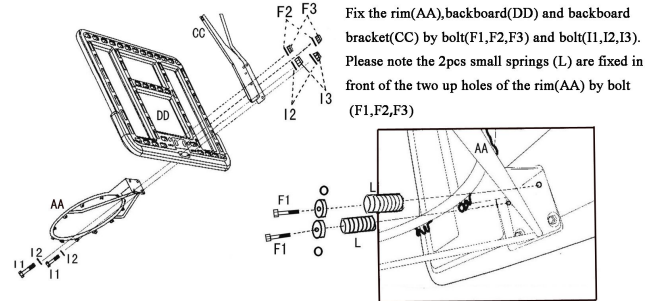

Fix the rim(AA), backboard(DD) and backboard bracket(CC) by bolt(F1,F2,F3) and bolt(I1,I2,I3). Please note the 2pcs small springs (L) are fixed in front of the two up holes of the rim(AA) by bolt (F1,F2,F3)

As shown in the below figure, pull the backboard bracket(CC) in both side

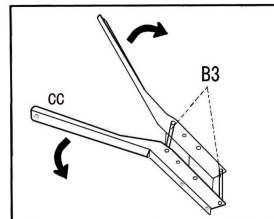

Fix the top end of backboard bracket(CC) behind the backboard(DD) by bolt(K1)

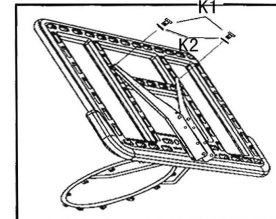

As shown in the figure, connect the backboard brace(S) and (T) on backboard bracket(CC) by bolt(B1,B2,B3,B4,B5). Please note that sleeve(B3) must be installed inside the backboard bracket(CC)

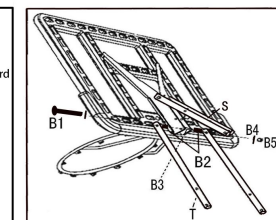
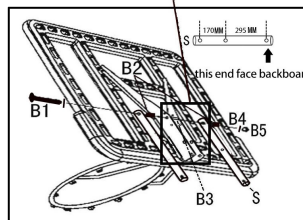

6

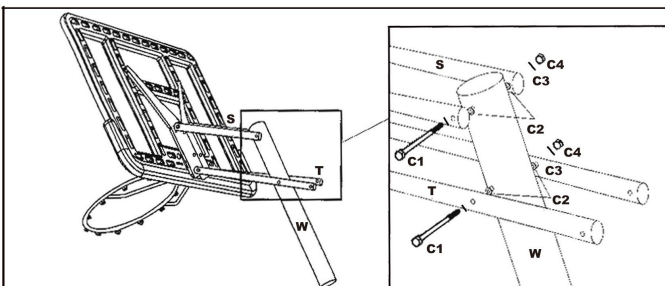

As shown in the above figure, install the backboard brace(T) and (S) on the top pole(W) by bolt(C1,C2,C3,C4)

As shown in below figure, fix the top end of outer lifter pole(HH) on the end of longer backboard brace(T) by bolt(A1,A2,A3,A4). Please note that sleeve(A2) must between the longer backboard (T) and outer lifter pole(HH).

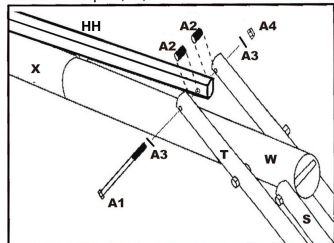

As shown in below figure, fix the end of inner lifter pole (GG) on triangular block(Q) by bolt (H1,H2,H3)

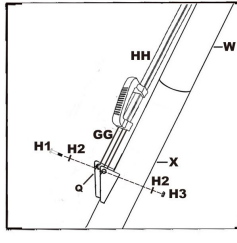

Fix the bolt(EE) on the two shorter backboard brace(S). In order to convenient the next installation of big springs (R)

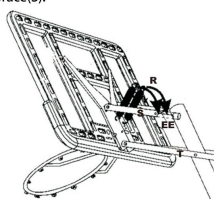
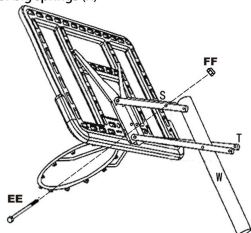

As shown in the figure, Fix one end of big springs (R) on the hole of the backboard bracket(CC), then hang the other end of the big springs(R) on bolt(EE)

7

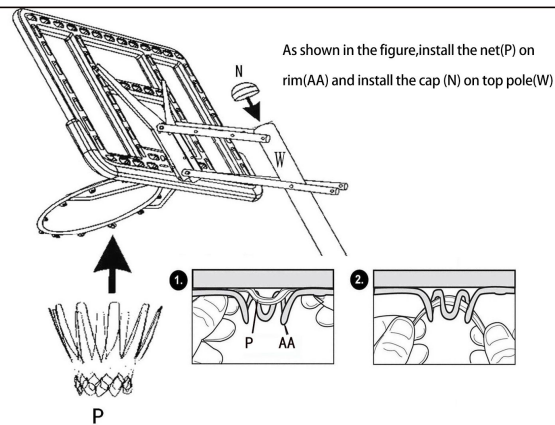

As shown in the figure, install the net(P) on rim(AA) and install the cap (N) on top pole(W)

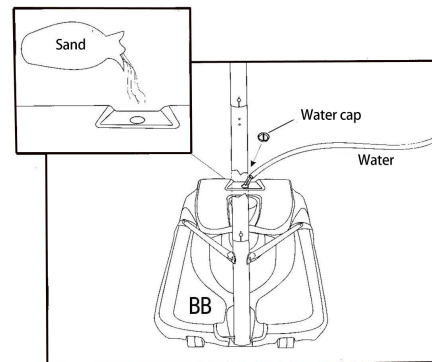

For safety reason, sand instead of water is recommended to fill up the base during the sub-freezing weather. Please note that sand will not be poured out once filled in the base

8